

F-M

Auch verfügbar für Scheibendicke 25,4 - 30 - 40 mm.
Available also for disc thickness 25,4 - 30 - 40 mm.

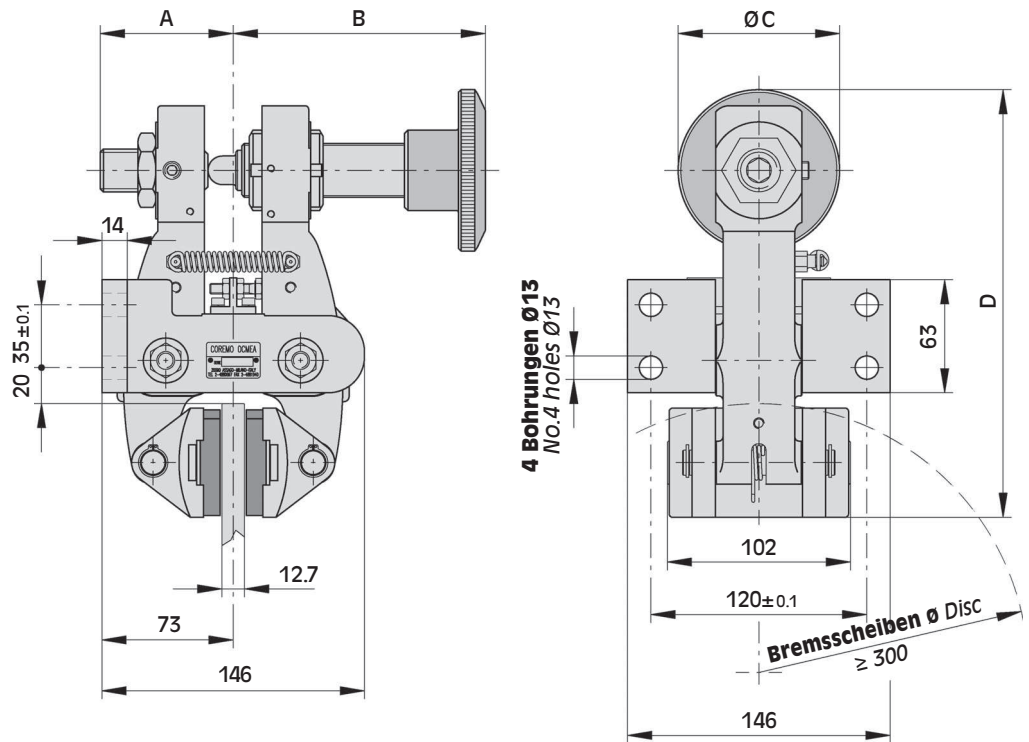
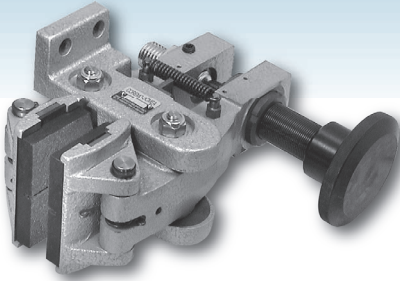

ABMESSUNGEN/DIMENSIONS

TYP SIZE	Teil-Nr Product Number	A	B	ØC	D	Gewicht Weight kg
F-M	A2750	74	140	90	238.5	9.6

Warnung: Das anfängliche Bremsmoment neuer Bremsen/Bremsbeläge kann um 30-50% zu den Katalogwerten verringert sein, bis Bremsbeläge u. - scheiben eingelaufen sind!
Warning: The initial torque on new units can be 30% to 50% less than the catalogue value until the friction facing and friction disc are lapped or worn in.

Techn. Daten

Bremskraft F:

F-M 2670 N 12 Umdrehungen Handrad

dyn. Bremsmoment:
 $= F \cdot (\text{Scheibenradius(m)} - 0.033) = \text{Nm}$

Max. Belagverschleiss: 12 mm

Bremsbelagsdicke (neu): 11 mm

Dauerwärmeleistung: Qc: 3.4 kW

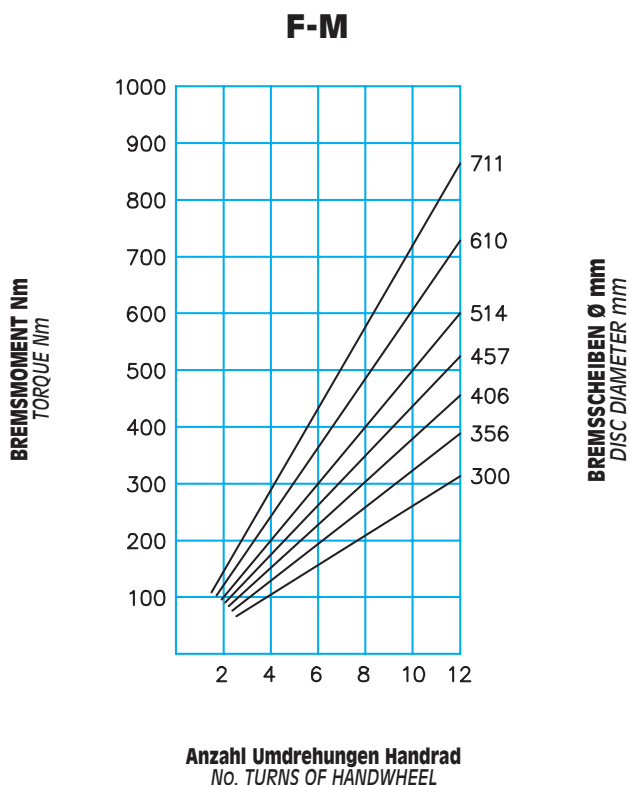

Technical data

Braking force F:

F-M 2670 N 12 turns of handwheel

Dynamic torque
 $= F \cdot (\text{disc radius in m} - 0.033) = \text{Nm}$

Max total wear: 12 mm

Thickness of new lining: 11 mm

Continuous thermal capacity
 Qc: 3.4 kW