

F

Auch verfügbar für Brems Scheibendicke 25,4 - 30 - 40 mm.
Available also for disc thickness 25,4 - 30 - 40 mm.

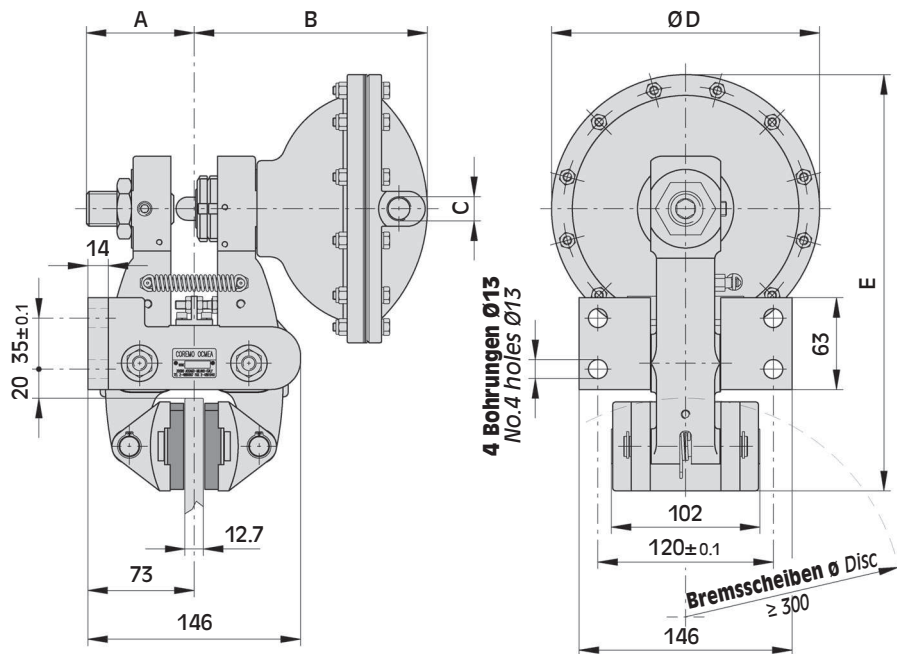
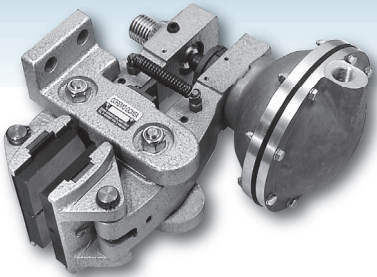

ABMESSUNGEN/DIMENSIONS

TYP SIZE	Teil-Nr Product Number	A	B	C	ØD	E	Luftvolumen Air Volume dm ³	Gewicht Weight kg
F05	A2758	75	107	1/4" Anschluss	74	230.5	0.025	9.2
F1	A2766	72.5	119.5	1/4" Anschluss	116	251.5	0.1	9.5
F2	A2774	72.5	141.5	3/8" Anschluss	142	264.5	0.2	10.3
F3	A2782	72.5	160	3/8" Anschluss	184	285.5	0.4	11.5

Warnung: Das anfängliche Bremsmoment neuer Bremsen/Bremsbeläge kann um 30-50% zu den Katalogwerten verringert sein, bis Bremsbeläge u. - scheiben eingelaufen sind!
Warning: The initial torque on new units can be 30% to 50% less than the catalogue value until the friction facing and friction disc are lapped or worn in.

Techn. Daten

Bremskraft F:

F05	1600 N bei 6 bar
F1	3800 N bei 6 bar
F2	7500 N bei 6 bar
F3	12700 N bei 6 bar

dyn. Bremsmoment:
 $= F \cdot (\text{Scheibenradius(m)} - 0.033) = \text{Nm}$

Max. Belagverschleiss: 12 mm

Bremsbelagsdicke (neu): 11 mm

Dauerwärmeleistung: Qc: 3.4 kW

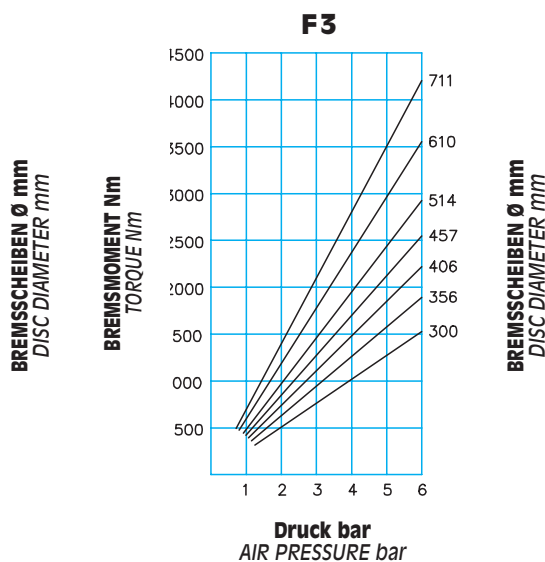
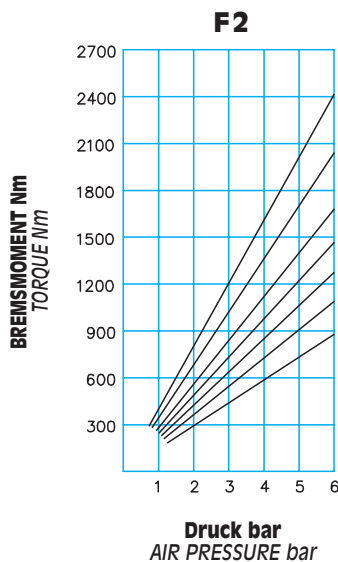
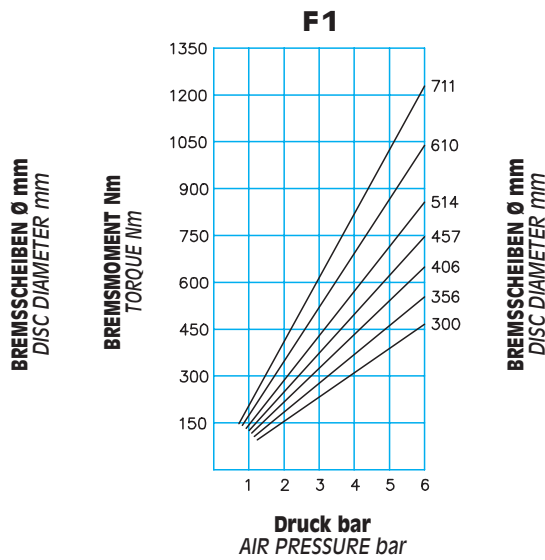
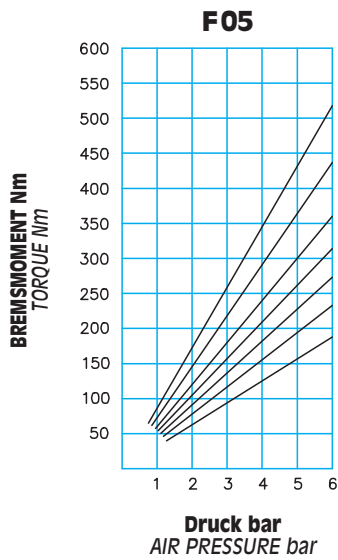

Technical data

Braking force F:

F05	1600 N at 6 bar
F1	3800 N at 6 bar
F2	7500 N at 6 bar
F3	12700 N at 6 bar

Dynamic torque
 $= F \cdot (\text{disc radius in m} - 0.033) = \text{Nm}$

Max total wear: 12 mm

Thickness of new lining: 11 mm

Continuous thermal capacity
 Qc: 3.4 kW

DIAGRAMM/CHART

Therm. Kapazität für Notstop

Thermal capacity for emergency stop

